

“Water Lily” Origami Pop-Up Card

(art + math; art + social studies)

For greetings, gifts or just for fun, students will enjoy making a pop-up card with a lovely, folded water lily tucked inside. Using the Japanese art of origami, the flower is made with 6 petals cut from one single template and folded so that the petals unfurl as the card is opened. For a cross-curricular link with a math lesson, have students use geometry skills to measure angles and create their own template for the pop-up (Step 1). For a faster project, use the template already created (on page 3) and simply cut out the petal pieces.



Grade Levels 5-8

Note: instructions and materials based on a class of 25 students. Adjust as needed.

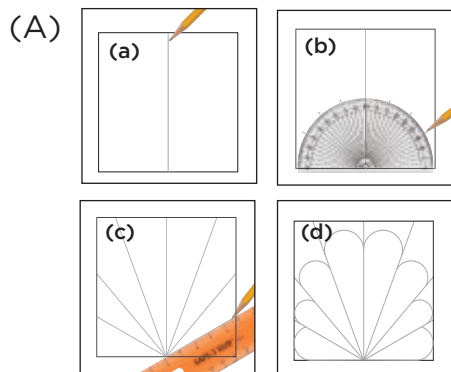

For a math lesson, have students draw the pattern using geometry tools, see step 1

Process

1. Have students create a pattern to follow, or use the one provided. To make the pattern, follow the steps in (A): take a 4" x 4" piece of posterboard, find the center with a ruler, and mark it with a line across the card (a). Align the centering mark and edge of the protractor on the edge of the card (b), then mark the following angles with a dot: 30°, 50°, 70°, 110°, 130° and 150°. Connect with pencil lines, using the ruler (c). Create scalloped edges between the angled lines by freehanding or using a compass (d).
2. Cut out the pattern with scissors. It will look like a sea-shell (B). With pencil, lightly number each petal, starting at the left, 1 through 8.

Materials

Strathmore Blank Greeting Cards, size 5" x 7", box of 50 (12940-1430), one per student

Blick Student Watercolor Paper, 90-lb (10028-2152), sheet size 22" x 30". Students will need six 4" x 4" pieces

6" Semicircular Protractor (55646-0006), one per student

Safe-T View Thru Rulers (55496-1012), one per student

School Pencil Compass (55491-1055), one per student

Blick Economy Graphite Pencils (20302-2009) one per student

Blick Art Gum Erasers (21507-1024) one per student

Snippy Scissors (57040-2009) one pair per student

Blick Glue Sticks (23872-1020), need one per student

Blick Economy Posterboard, white one side (13109-1102), one 4" x 4" square per student

General's® Kimberly® Watercolor pencils, assorted color 144-piece classpack (20502-9012)

Sargent Art Glitter Glaze (00704-1006), place in small cups to distribute to class

Blick Economy Camel Hair brushes, size 6 (05153-1006), one per student

Bone folder, optional (12964-0001)

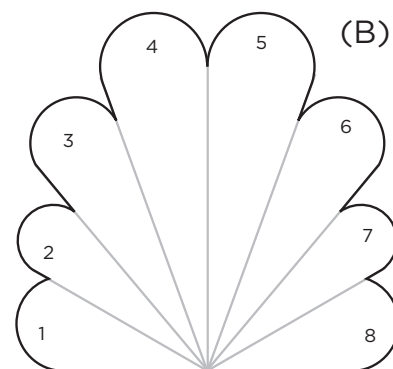

This illustration may be used as a pattern to save time. Shown at 50%, full size pattern on page 3

Process, continued

- Using watercolor pencils, apply color over each 4" x 4" piece of watercolor paper, front and back. Use a combination of a light color with a darker color for best results. Use a small amount of the Glitter Glaze on a brush to moisten and blend the color. Allow first side to dry, then apply glaze to the second side. Use the same process to paint the card on the inside and the outside. Allow to dry.
- Trace the pattern onto each of the 6 pieces of watercolor paper and cut out with scissors. HINT: the paper is lightweight enough to cut 2 or 3 pieces at a time if you need to save time.

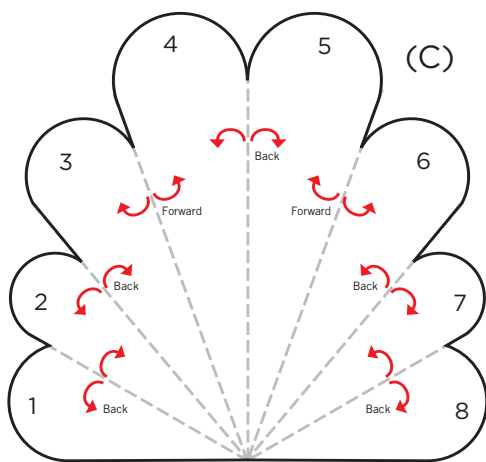

- Fold each petal, origami style. Begin with the center fold, create a hard crease back. A bone folder is helpful in creating a strong crease. Fold the next angle forward, and the next two back (C). Use a small piece of tape to secure petals 1 and 8 together (D), if desired.

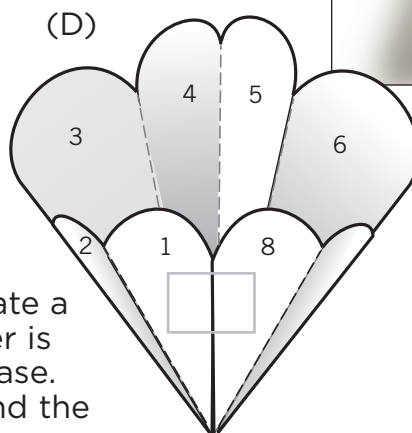

secure petals 1 and 8 together with a small piece of tape

- On the Blank Greeting Card, measure and mark the center on the fold. Position two of the folded pieces with points at the center, glue petals 1 & 8 to the card (E). These will be the center pieces of the flower.
- The remaining folded pieces will be the sides of the flower, and will need to be trimmed in order for the card to close properly. On two of the pieces, trim away petals 1 and 2. On the other two pieces, trim away petals 7 and 8. Attach the first flower side to the right of one of the center pieces, gluing petal 1 to the card

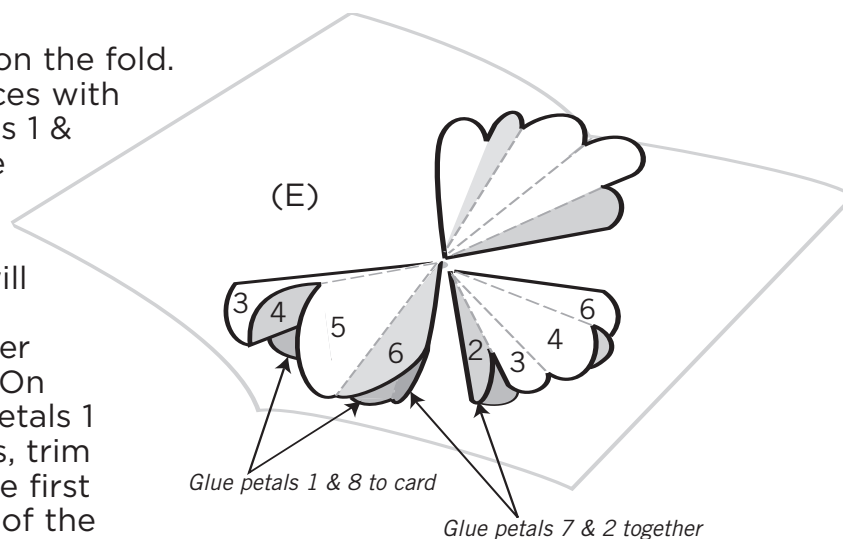

Glue petals 1 & 8 to card

Glue petals 7 & 2 together

and 2 to the side of the center (on it's petal 2). Repeat to the right of the other center piece. Repeat with remaining flower sides on the left of the center pieces, this time gluing petal 8 to the card and 7 to the center pieces. Do not glue the sides of the flower together, they will overlap as the card folds down.

- Allow the glue to dry completely before gently folding card. Use a brush or calligraphy marker to write a message around the flower and on the front of the card. Insert into the included envelope, and it's ready to send.



Easy Variation (above):

For a faster project, use [Folia Origami Sheets \(12233-1033\)](#) instead of watercolor paper and eliminate step 3. Glue 2 light blue sheets to the card first for water. Cut oval-shaped leaves from light or dark green sheets and glue on top the blue. Use the remaining colors (reds, yellows, pinks, purples) for petals. Follow steps 4-8 to create the water lily.

National Standards:

Content Standard #1 — Understanding and applying media, techniques and processes

- **5-8** Students intentionally take advantage of the qualities and characteristics of art media, techniques and processes to enhance communication of their experience and ideas.

Content Standard #6 — Making connections between visual arts and other disciplines

- **5-8** Students describe ways in which the principles and subject matter of other disciplines taught in the school are interrelated with the visual arts.

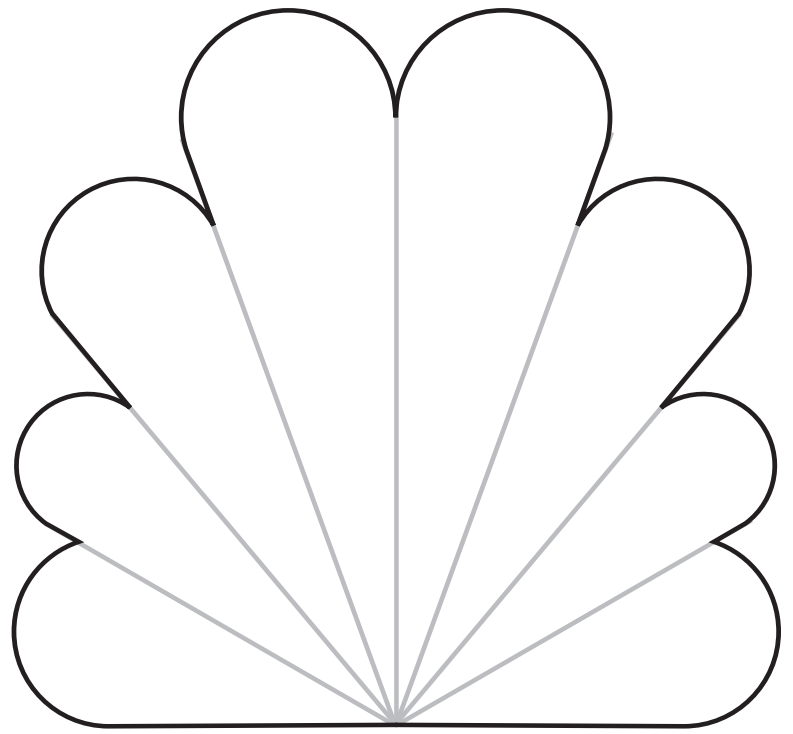

template